

## SMD 3528 Constant Current LED Strip Light 120LED/M

### Constant Current SMD 3528 Led Strip Lights manufacturer

Hanron Lighting Co. Limited's SMD 3528 constant current LED Flexible Strip Lighting, 120LED/Meter, both waterproof and non-waterproof, is to satisfy customers seeking a high brightness of the lighting and brilliant color effects. By using build-in constant current IC, they obtain longer lifespan, longer in connection and uniform brightness. They are ideal light source for home decoration, hotel, KTV, cove ect.

#### Features of SMD 3528 Constant Current LED Strip Light 120LED/M:

1. TOP SMD3528 chip, high brightness, wide beam angle, low decay.
2. With build-in constant current IC, longer lifespan
3. Cuttable for each group, convenient for using
4. Longer in connection, uniform brightness
5. Easy to install for any bending
6. DC24V, safe and fit for universal use
7. Certification: CE & RoHS

#### Application of SMD 3528 Constant Current LED Strip Light 120LED/M:

1. Cove lighting
2. Architectural lights for canopy, corridor, window, archway
3. Backlight or edge lighting for signage
4. DIY lights for home use
5. Path and contour marking
6. Decorative lights for holiday, event, show, exhibition
7. Special light effect for art gallery and glass-made items

#### Parameter of SMD 3528 Constant Current LED Strip Light 120LED/M

Item NO.	LED Type	LED QTY (PCS)	Current (mA)	Voltage (V)	Power (W/M)	Color	Wave Length/C. T.	Luminous Flux/M	Protect Level
HR10-A12ANW120P	SMD3528	120	20	DC22-DC26	9.6	W	5500-6500K	780LM±10%	IP20/ IP65/ IP67/ IP68
HR10-A12AWW120P	SMD3528	120	20	DC22-DC26	9.6	WW	2800-3200K	780LM±10%	
HR10-A12ACW120P	SMD3528	120	20	DC22-DC26	9.6	CW	9000-12000K	780LM±10%	
HR10-A12AR120P	SMD3528	120	20	DC22-DC26	9.6	RED	620-630nm	240LM±10%	
HR10-A12AY120P	SMD3528	120	20	DC22-DC26	9.6	YELLOW	585-595nm	240LM±10%	
HR10-A12AB120P	SMD3528	120	20	DC22-DC26	9.6	BLUE	465-475nm	144LM±10%	
HR10-A12AG120P	SMD3528	120	20	DC22-DC26	9.6	GREEN	520-530nm	420LM±10%	

## Performance Curve of SMD 3528 Constant Current LED Strip Light 120LED/M

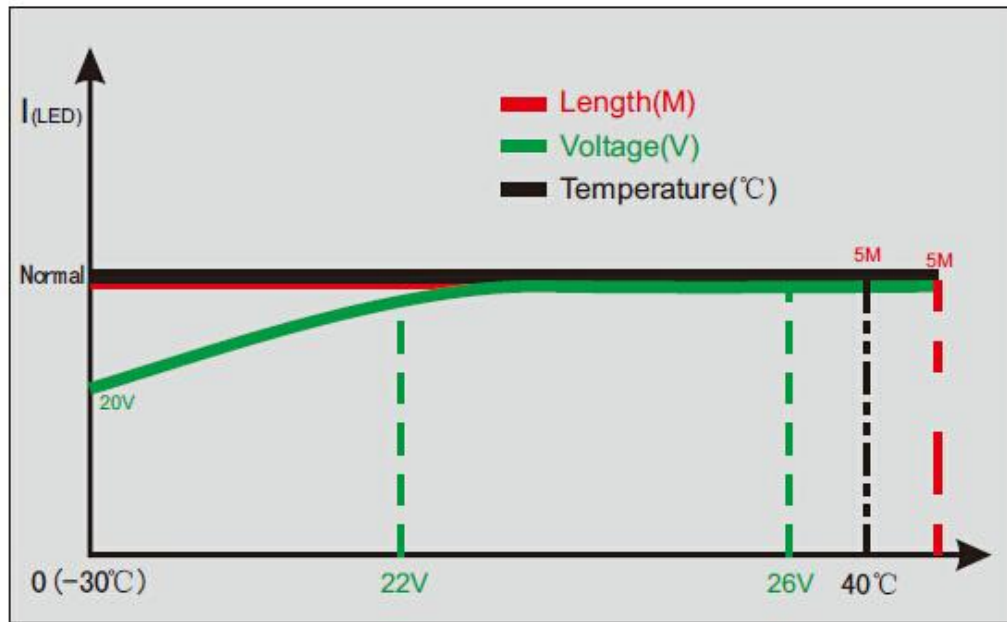

Diagram 1: Curve graph of performance characteristic

### 1. Wide range of working temperature(-30°C~40°C)

The current of LED keep stable from -30 ~40 .Uniform brightness, good performance. Better protect the LED from damage (as shown in black line)

### 2. Long connection (Max: 10M)

Single end input, uniform brightness, good for connection (as shown in red line)

### 3. Wide voltage (22V~26V)

Voltage keeps stable within range, constant current good for L ED ( a s shown in green line)

### Dimension:

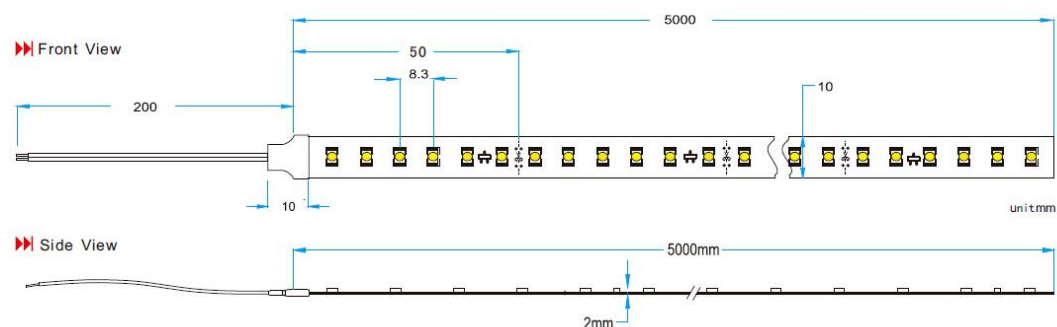

### Connect Drawing:

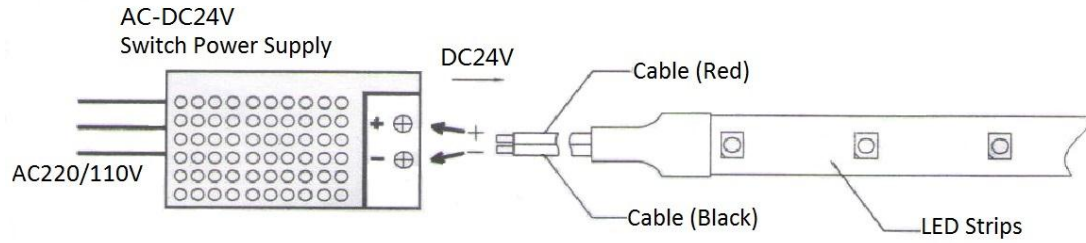

## Installation of SMD 3528 Constant Current LED Strip Light 120LED/M

1. The black of strip stick with 3M tape. Only need to rive the face paper on 3M tape when use.
2. Stick the strip anywhere 3M tape easy to fix.
3. When install strips, it can be cut at the marks of scissors according to length.
4. Fix the strips with screw of clip lock.

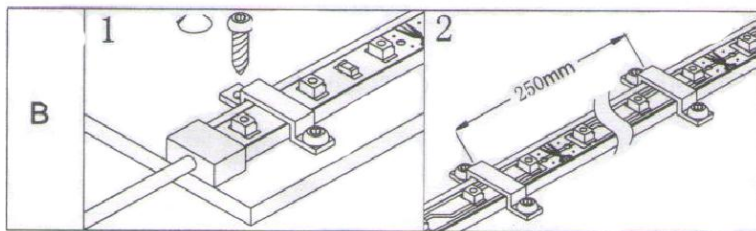
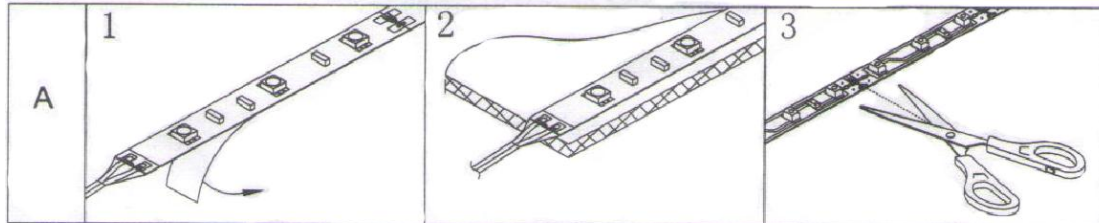

- A. Installation with 3M tape
- B. Installation with mounting Clip

### Packaging:

1. Diagram

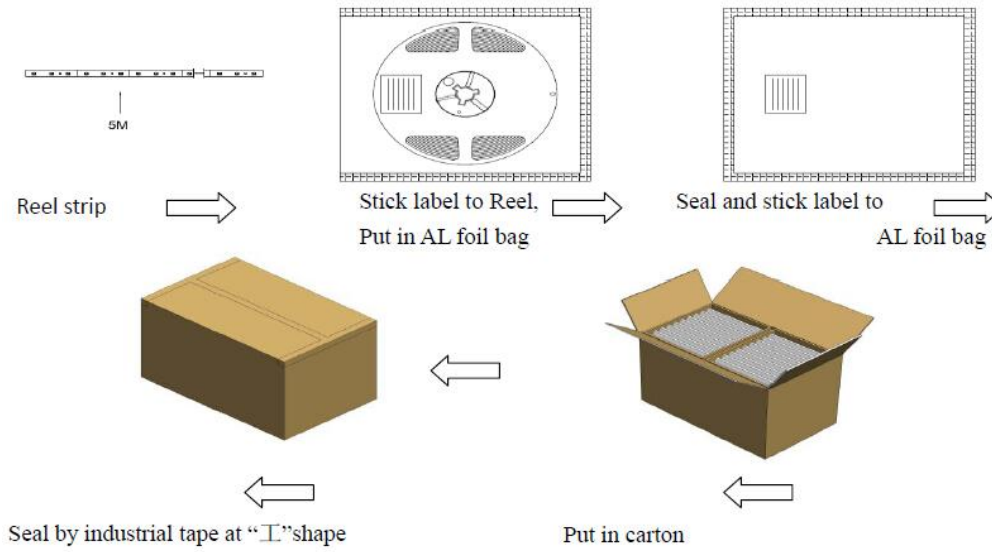

## 2. Notes from Constant Current SMD 3528 Led Strip Lights supplier in China - Hanron

\*Reel each strip (5M) by one and put in AL foil bag;

\*Put 15 reels into one inner box, total 75M strip;

\*Put 2 inner boxes into one carton, total 150M strip.