

SMD 3528 Constant Current LED Strip Lighting 240LED/M

Constant Current 3528 LED Strip Lighting manufacturer

Hanron Lighting Co. Limited's SMD 3528 constant current LED Flexible Strip Lighting, 240LED/Meter, both waterproof and non-waterproof, is to satisfy customers seeking a high brightness of the lighting and brilliant color effects. By using build-in constant current IC, they obtain longer lifespan, longer in connection and uniform brightness. They are ideal light source for home decoration, hotel, KTV, cove ect.

Features of SMD 3528 Constant Current LED Strip Lighting 240LED/M:

1. TOP SMD3528 chip, high brightness, wide beam angle, low decay.
2. With build-in constant current IC, longer lifespan
3. Cuttable for each group, convenient for using
4. Longer in connection, uniform brightness
5. Easy to install for any bending
6. DC24V, safe and fit for universal use
7. Certification: CE & RoHS

Application of SMD 3528 Constant Current LED Strip Lighting 240LED/M:

1. Cove lighting
2. Architectural lights for canopy, corridor, window, archway
3. Backlight or edge lighting for signage
4. DIY lights for home use
5. Path and contour marking
6. Decorative lights for holiday, event, show, exhibition
7. Special light effect for art gallery and glass-made items

Parameter of SMD 3528 Constant Current LED Strip Lighting 240LED/M

Item NO.	LED Type	LED QTY (PCS)	Current (mA)	Voltage (V)	Power (W/M)	Color	Wave Length/C. T.	Luminous Flux/M	Protect Level
HR10-A12ANW240P	SMD3528	240	20	DC22-DC26	19.2	W	5500-6500K	1560LM±10%	IP20/
HR10-A12AWW240P	SMD3528	240	20	DC22-DC26	19.2	WW	2800-3200K	1560LM±10%	IP65/
HR10-A12ACW240P	SMD3528	240	20	DC22-DC26	19.2	CW	9000-12000K	1560LM±10%	IP67/
HR10-A12AR240P	SMD3528	240	20	DC22-DC26	19.2	RED	620-630nm	480LM±10%	IP68

HR10-A12AY240P	SMD3528	240	20	DC22-DC26	19.2	YELLOW	585-595nm	480LM±10%
HR10-A12AB240P	SMD3528	240	20	DC22-DC26	19.2	BLUE	465-475nm	288LM±10%
HR10-A12AG240P	SMD3528	240	20	DC22-DC26	19.2	GREEN	520-530nm	840LM±10%

Performance Curve of SMD 3528 Constant Current LED Strip Lighting 240LED/M

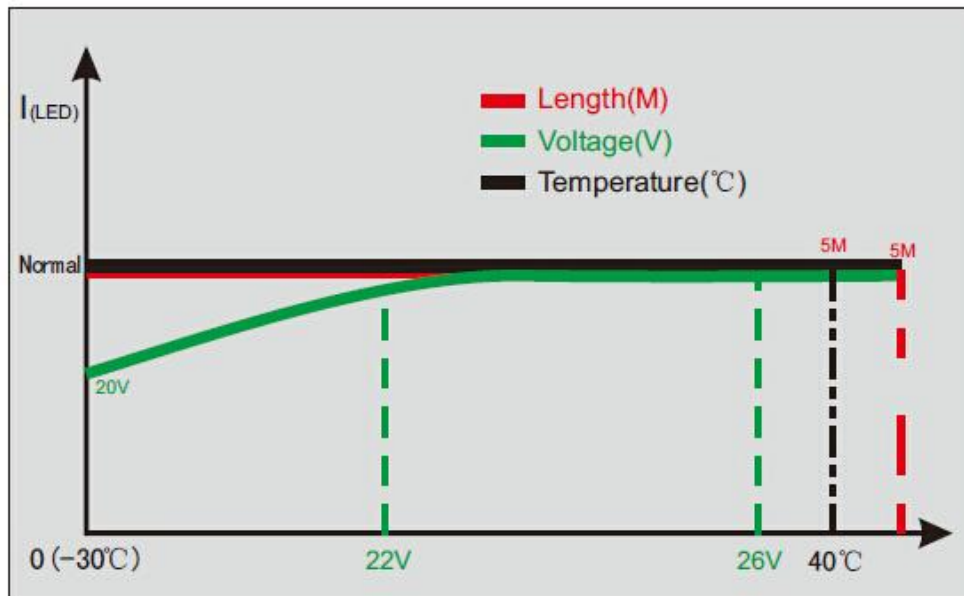

Diagram 1: Curve graph of performance characteristic

1. Wide range of working temperature(-30°C~40°C)

The current of LED keep stable from -30 ~40 .Uniform brightness, good performance. Better protect the LED from damage (as shown in black line)

2. Long connection (Max: 10M)

Single end input, uniform brightness, good for connection (as shown in red line)

3. Wide voltage (22V~26V)

Voltage keeps stable within range, constant current good for L ED (as shown in green line)

Dimension:

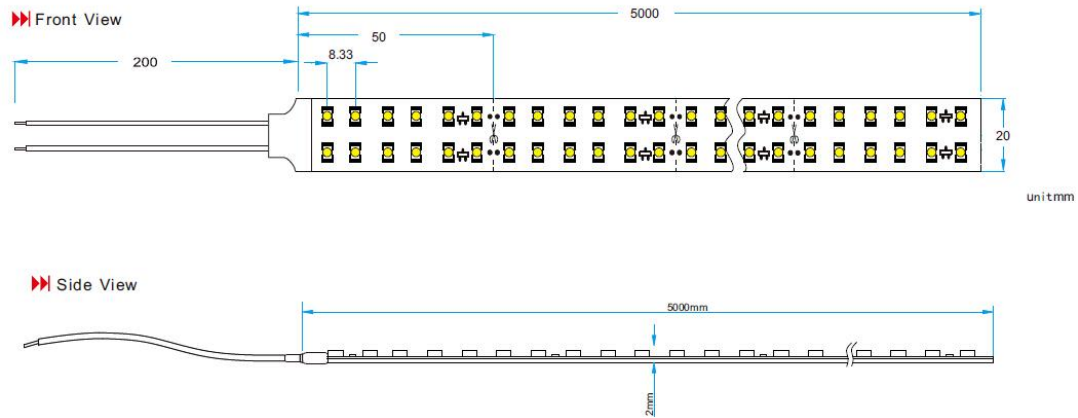

Connect Drawing:

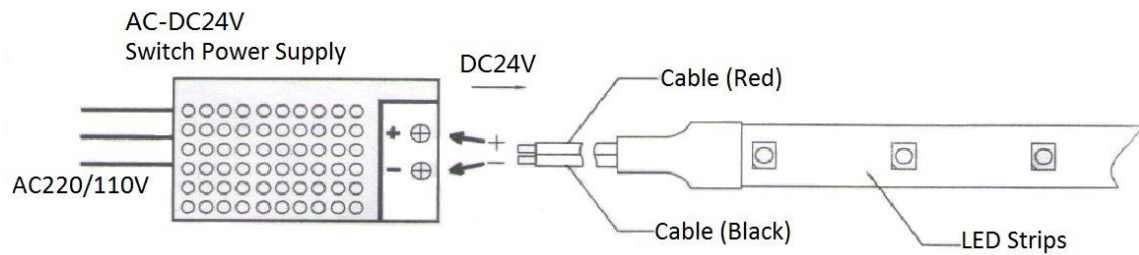

Installation of SMD 3528 Constant Current LED Strip Lighting 240LED/M

1. The black of strip stick with 3M tape. Only need to rive the face paper on 3M tape when use.
2. Stick the strip anywhere 3M tape easy to fix.
3. When install strips, it can be cut at the marks of scissors according to length.
4. Fix the strips with screw of clip lock.



- A. Installation with 3M tape
- B. Installation with mounting Clip

Packaging:

1. Diagram

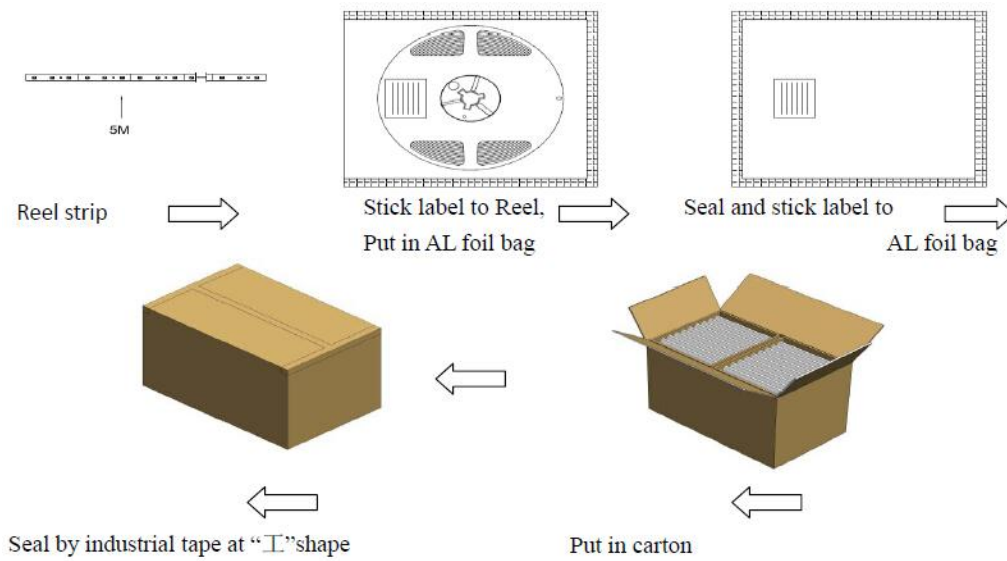

2. Notes from Constant Current 3528 LED Strip Lighting supplier in China - Hanron:

*Reel each strip (5M) by one and put in AL foil bag;

*Put 15 reels into one inner box, total 75M strip;

*Put 2 inner boxes into one carton, total 150M strip.