

## SMD 3528 CCT Adjustable LED Strip Light

Hanron Lighting Co. Limited's SMD 3528 CCT Adjustable [LED Flexible Strip Lights](#), both [waterproof led lightstrips](#) and non-waterproof, is to satisfy customers seeking a high brightness of the lighting and brilliant color effects. By using build-in constant current IC, they obtain longer lifespan, longer in connection and uniform brightness. They are ideal light source for home decoration, hotel, KTV, cove ect.

### Features:

1. TOP SMD3528 chip, high brightness, wide beam angle, low decay.
2. Cuttable for each group, convenient for using
3. Longer in connection, uniform brightness
4. Easy to install for any bending
5. DC12V, safe and fit for universal use
6. Certification: CE & RoHS

### Application:

1. Cove lighting
2. Architectural lights for canopy, corridor, window, archway
3. Backlight or edge lighting for signage
4. DIY lights for home use
5. Path and contour marking
6. Decorative lights for holiday, event, show, exhibition
7. Special light effect for art gallery and glass -made items

### Parameter

Item NO.	Color	LED TYPE	LED QTY (PCS)	DIMENSION (MM)	FPC (Type/Color)	VOLTAGE (V)	POWER (W/M)	PACKAGE
HR00-A12ANWWW60P	NW+WW	SMD3528	60	5000*8	Double side/White	DC12	4.8	5m/Reel
HR00-A12ANWWW72P	NW+WW	SMD3528	72	5000*8	Double side/White	DC12	5.76	5m/Reel
HR00-A12ANWWW120P	NW+WW	SMD3528	120	5000*10	Double side/White	DC12	9.6	5m/Reel
HR00-A12ANWWW240P	NW+WW	SMD3528	240	5000*20	Double side/White	DC12	19.2	5m/Reel

## Performance Curve

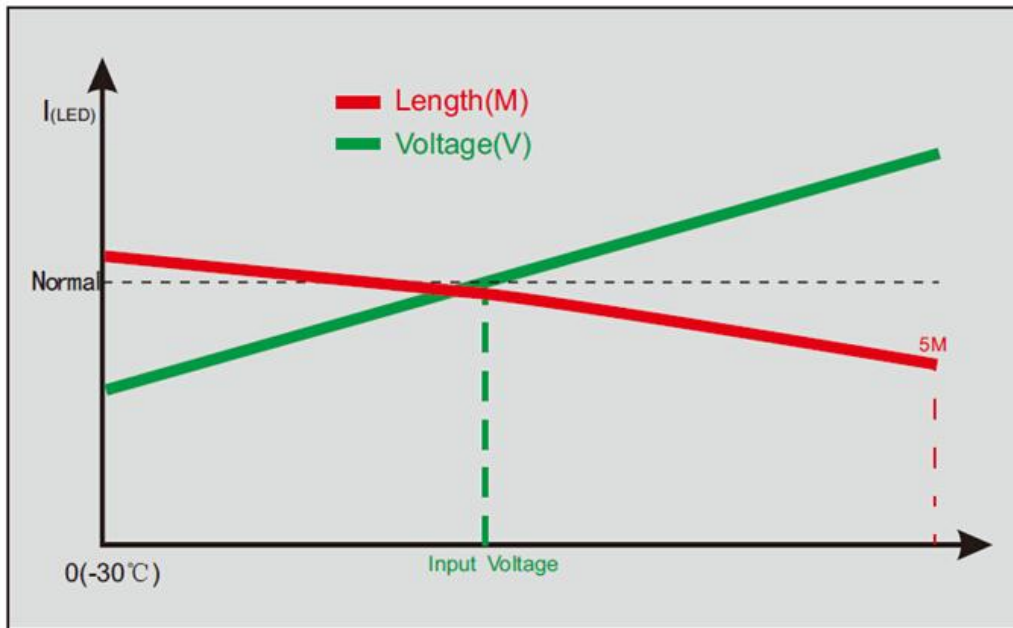

Diagram 1: Curve graph of performance characteristic

### 1. Working Voltage

In order to ensure the product performance, the input voltage should be within 5%, or it would lead to the brightness unbalance and effect the lifespan of the product. Working voltage curve: green curve

### 2. Continuous Length

In order to ensure the product performance, the suggested length is 5M through bilateral input. Long distance connection should be parallel. Unilateral input or over length would lead to brightness unbalance.

## Dimension:

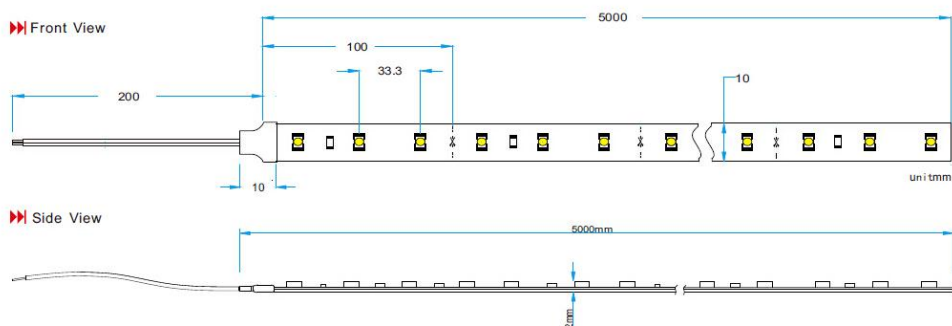

## Connect Drawing:

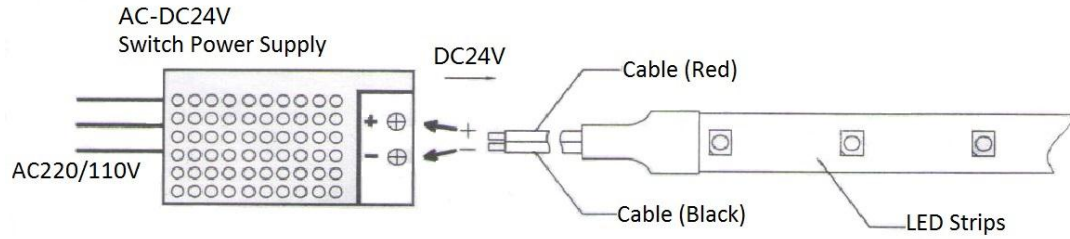

## Installation

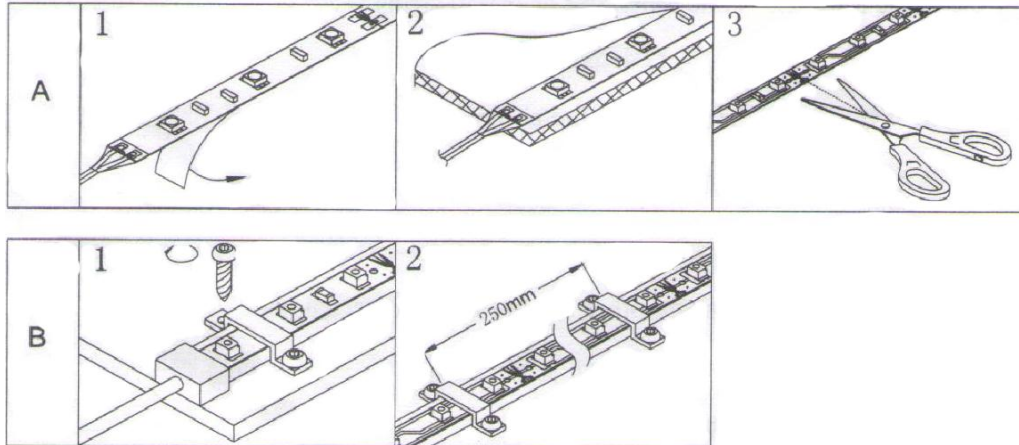

1. The black of strip stick with 3M tape. Only need to rive the face paper on 3M tape when use.
2. Stick the strip anywhere 3M tape easy to fix.
3. When install strips, it can be cut at the marks of scissors according to length.
4. Fix the strips with screw of clip lock.



- A. Installation with 3M tape
- B. Installation with mounting Clip

## Packaging:

1. Diagram

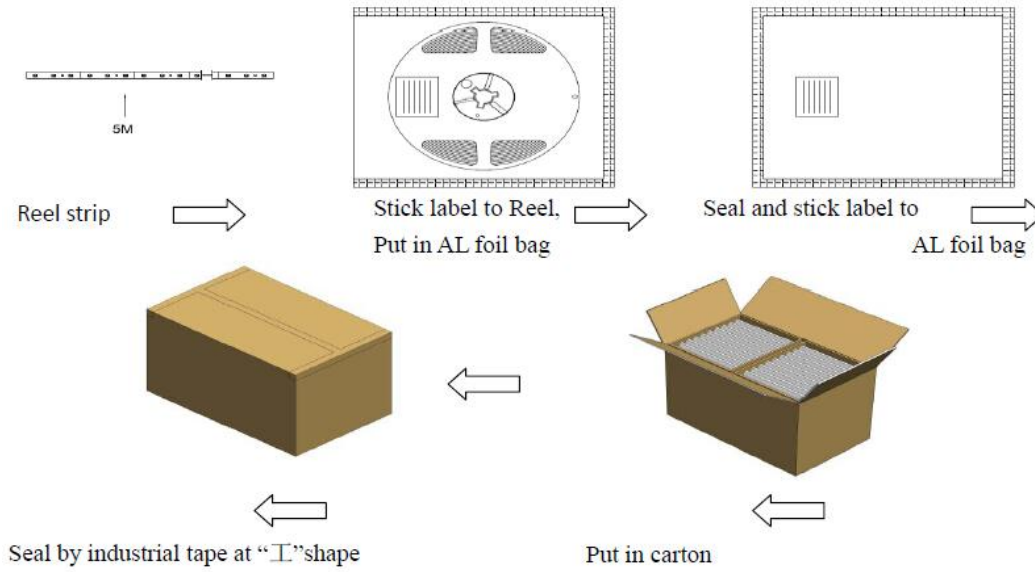

## 2. Notes:

\*Reel each strip (5M) by one and put in AL foil bag;

\*Put 15 reels into one inner box, total 75M strip;

\*Put 2 inner boxes into one carton, total 150M strip.